

# DIY WINDOW CATIO

Follow the steps below to create your own “Window Catio”. This design uses any window in your house to create an outdoor space for your cats to enjoy!

## SHOPPING LIST

- ☐ 12 **2X2** BOARDS for walls
- ☐ 2 **2X4** BOARDS for support brackets
- ☐ 2 **5/8** PLYWOOD SHEETS for floor+roof of enclosure
- ☐ **1X1** WIRE MESH stainless steel or galvanized to avoid weather damage
- ☐ 3 **1/2** INCH DECK SCREWS
- ☐ **3/4** INCH OR LONGER STAPLES
- ☐ DRILL BITS slightly more narrow than screw width
- ☐ WIRE/TIN SNIPS to cut mesh to correct size
- ☐ CIRCULAR SAW and/or TABLE SAW
- ☐ ELECTRIC DRILL
- ☐ STAPLE GUN



When choosing wood: make it **cedar**! Cedar wood is extremely durable, and holds up well to outdoor weather conditions. Also, the wood's natural oils help to deter insect damage and rotting.



A note on **plywood**: Untreated plywood, if exposed to the elements, could break down or mold. Make sure to use a pet safe wood preservative, like paint or oil. Look for products that are water based, free from heavy metals, Low VOC, and avoid creosote. Treated plywood should not be used near ponds and streams because it is toxic to aquatic life.

All measurements provided below are included as an example! Plans can be modified for your existing space. Additionally, houses are not always straight, square, or level. Adjust the catio dimensions to fit the "personality" of your house.

## STEPS TO ASSEMBLE:

**1.** Measure and record all the dimensions of your window, as well as the depth the catio will be from the window. Additionally, find a stud (vertical support in the wall) to attach your structure to. Remember to measure twice and cut once.

**2.** Create the front wall of your catio by cutting the **2x2** boards to the correct dimensions. Drill a pilot hole (a guide hole for our screw to go into) near the end of each **2x2** that is slightly smaller than the screw thickness you are using. Drill the pilot holes at .75 inches from the edge of the board to prevent the wood from splitting. Use **3 1/2** inch screws to connect the lumber.

**Note:** For better weatherproofing, create a sloped roof! This requires angle cuts on the front and side pieces, with the front sitting slightly lower than the back.

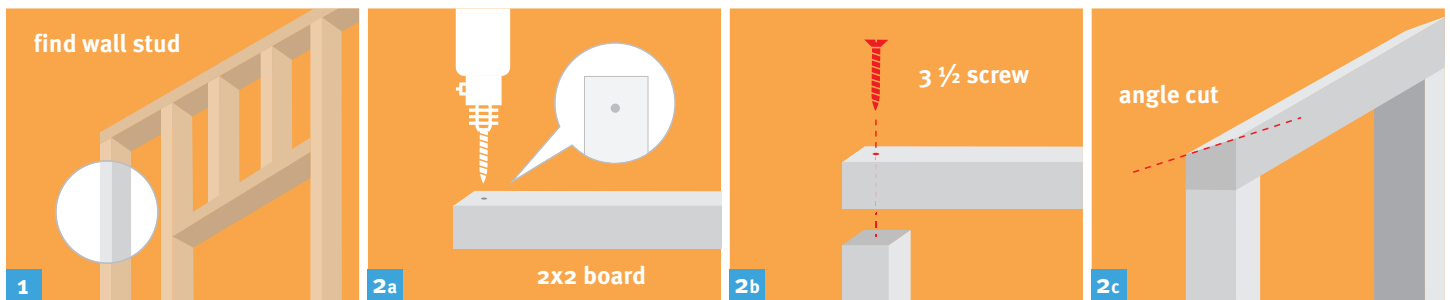

## STEPS TO ASSEMBLE (CONT-ED):

**3.** Build the 2 side walls of your catio following the same procedures as step 2.

**4.** Attach the **1x1** mesh to the outside of each wall. Use staples to lock the mesh into place. Cut any extra mesh off using the wire snips to avoid injuries to yourself or your cat!

**5.** Assemble the frame of the catio. Join the three walls together tightly by first aligning the edges flush and drilling two pilot holes, evenly spaced on the end of the **2x2**. Then use 2, **3 1/2** inch screws to lock them in place.

**6.** Measure the **5/8** sheet of plywood to fit inside your frame, this is the floor of your enclosure. Attach the floor of your catio to the frame using **3 1/2** inch screws. Screws should be placed at least 1 inch from the edge of the plywood board to prevent the board from splitting.

**7.** Attach your 2nd **5/8** sheet of plywood to the top of your frame using **3 1/2** inch screws, at least 1 inch from the end of board. This is the roof of your enclosure. For extra waterproofing, add shingles (or other roof panels) to your roof, attaching them with staples.

**8.** Make your support brackets using **2x4** boards cut to size. Two boards have even cuts, while the third has 45-degree angle cut on each end. Drill 2 pilot holes, evenly spaced on the end of the **2x4**. Use **3 1/2** inch screws to create your “triangle brackets”.

**9.** Using the 2 support brackets and **3 1/2** inch screws, attach your catio to a stud (vertical support in the wall) on your exterior wall. After drilling pilot holes, use additional **3 1/2** inch screws to attach the frame of your catio on all sides of the window frame.

**Note:** If you are attaching your catio into exterior wall stucco or vinyl siding additional steps are required. For stucco, after drilling your pilot holes apply a small amount of caulk inside the hole. Then insert a screw anchor into the hole. For vinyl siding, only screw into studs to avoid electrical wires.

